

IKO Roller Followers RoHS compliant

IKO Roller Followers are bearings designed for outer ring rotation, in which needle rollers are incorporated in a thick walled outer ring. Roller Followers include separable and non-separable types. These bearings are available in a variety of types to suit almost any kind of application. They are widely used for cam mechanisms and for linear motions of conveying equipment.

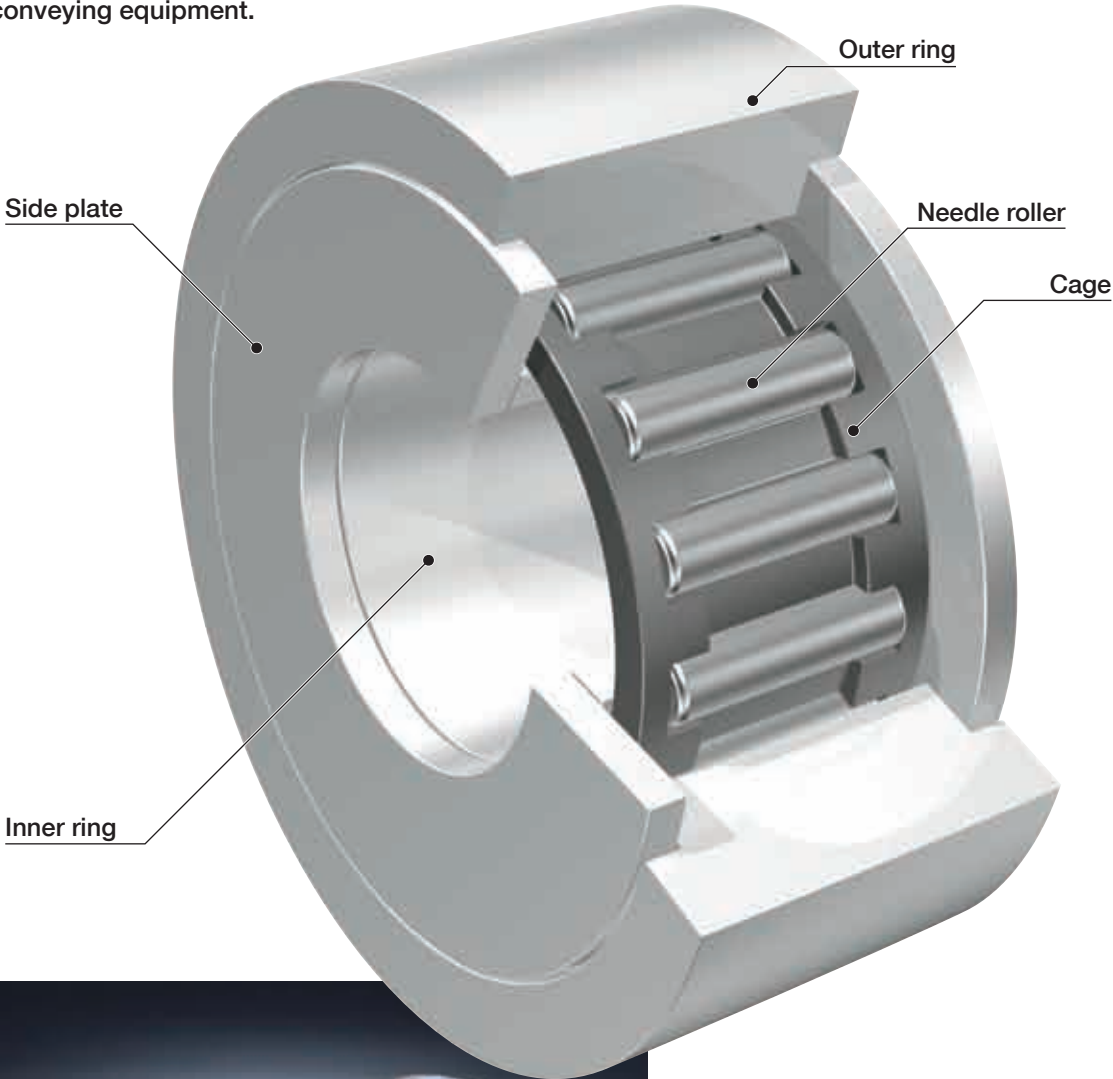

Roller Followers



Roller Follower Series with reliability and actual operation results

Separable Roller Followers

NAST

Combining an outer ring, inner ring and Needle Roller Cage, which can be separated from one another, assembles these bearings. Thus, handling is easy. Oil lubrication is also easy, making them suitable for high-speed rotations. There are two types: type without inner ring RNAS and type with inner ring NAST.

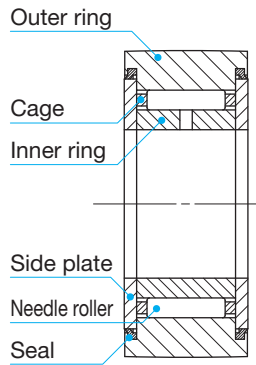

Selectable product specifications

Roller guide type	No symbol		Caged
	V		Full complement
Seal structure	No symbol		Open type
	ZZ		Shield type
	ZZUU		Sealed type
Shape of outer ring	No symbol		Cylindrical outer ring
	R		Crowned outer ring

To page

Non-Separable Roller Followers

NART

These non-separable type bearings have side plates fixed on both sides of the inner ring, and include the caged type and the full complement type.

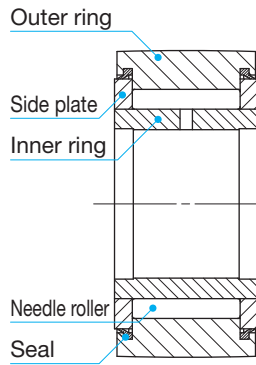

Selectable product specifications

Roller guide type	No symbol		Caged
	V		Full complement
Seal structure	No symbol		Shield type
	UU		Sealed type
Shape of outer ring	No symbol		Cylindrical outer ring
	R		Crowned outer ring

To page

Cylindrical Roller Followers

NURT

These full complement type bearings incorporate cylindrical rollers in the outer ring in two rows and can withstand large radial loads and some axial loads.

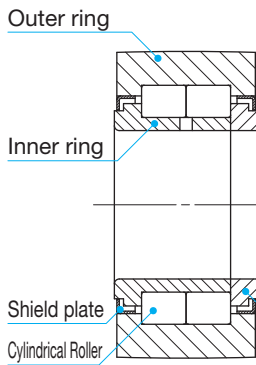

Selectable product specifications

Roller guide type	No symbol		Full complement
	V		Caged
Seal structure	No symbol		Shield type
	UU		Sealed type
Shape of outer ring	No symbol		Cylindrical outer ring
	R		Crowned outer ring

To page

Non-Separable Roller Followers, Inch Series

CRY

CRY type is Inch Series of NART series, which has large load capacity, coated with black oxide film treatment.

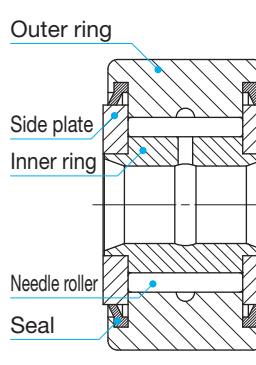

Selectable product specifications

Roller guide type	No symbol		Caged
	V		Full complement
Seal structure	No symbol		Shield type
	UU		Sealed type
Shape of outer ring	No symbol		Cylindrical outer ring
	R		Crowned outer ring

To page